

HEATHY WOOD
COPTHORNE





COPTHORNE

Situated on the leafy outskirts of the historic village of Copthorne, Heathy Wood will offer a range of 2, 3, 4, and 5 bedroom homes from our two product ranges Pure and Core.

THE KEMBLE PLOT 45



2 BED TERRACE HOME



2 PARKING SPACES

HEATHY

Copthorne Way, Copthorne, Crawley, West Sussex RH10



The Kemble - Pure is the perfect home for those looking for both relaxation and a space to entertain family and friends. Two bedrooms bring ample opportunities for personalisation to the upper level, with floor-to-ceiling windows helping emphasise the space within.

WITH FEATURES WE LOVE

- Energy efficient Nest Learning Thermostat
- Smart Ring 2 Video Doorbell
- Floor-to-ceiling windows
- Family bathroom

HEATHY WOOD **COPTHORNE**

A first for St. Modwen Homes, Heathy Wood features contemporary house types from our signature Core range as well as homes from our all-new Pure range.



FLOORPLANS

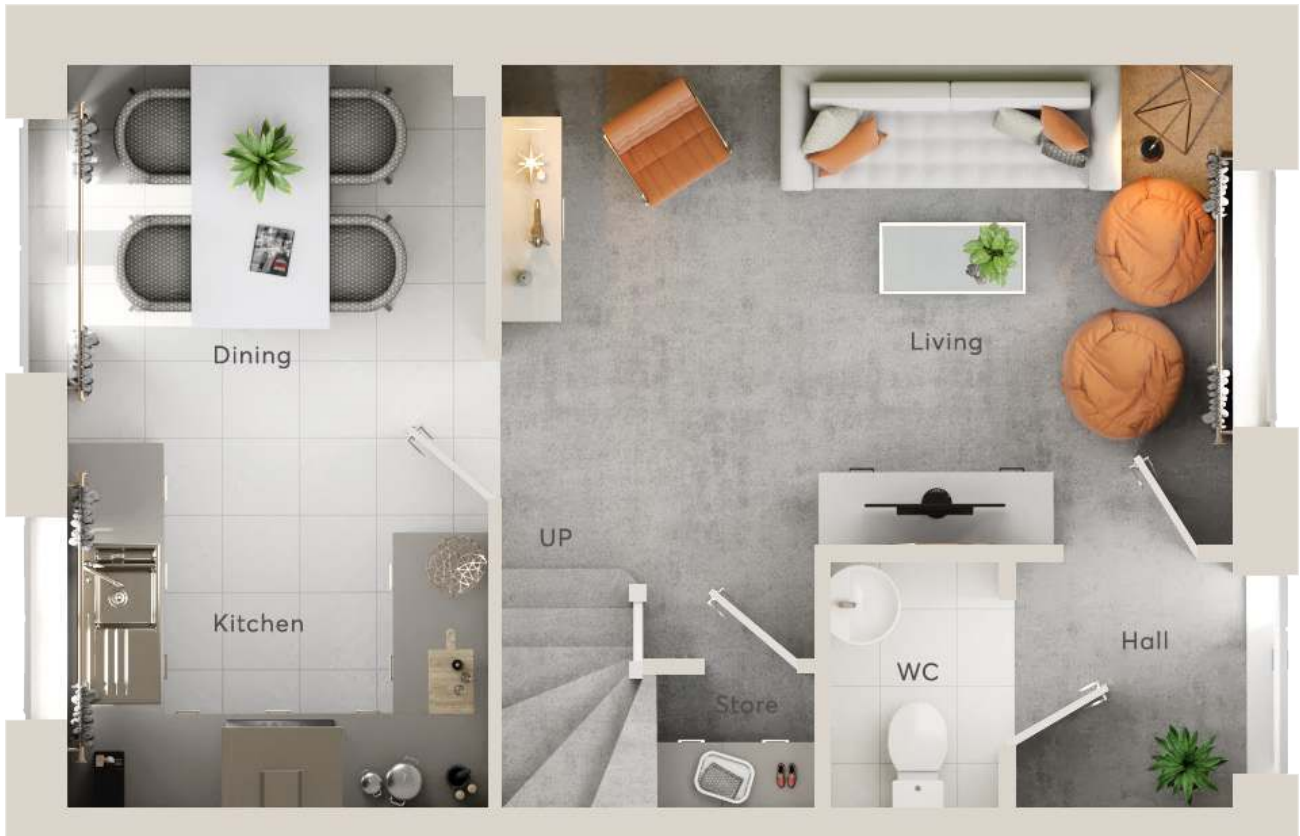

GROUND FLOOR

Living Room
Kitchen/Dining

9'9" x 14'9"
15'0" x 9'11"

2.96m x 4.49m
4.57m x 3.03m

FLOORPLANS

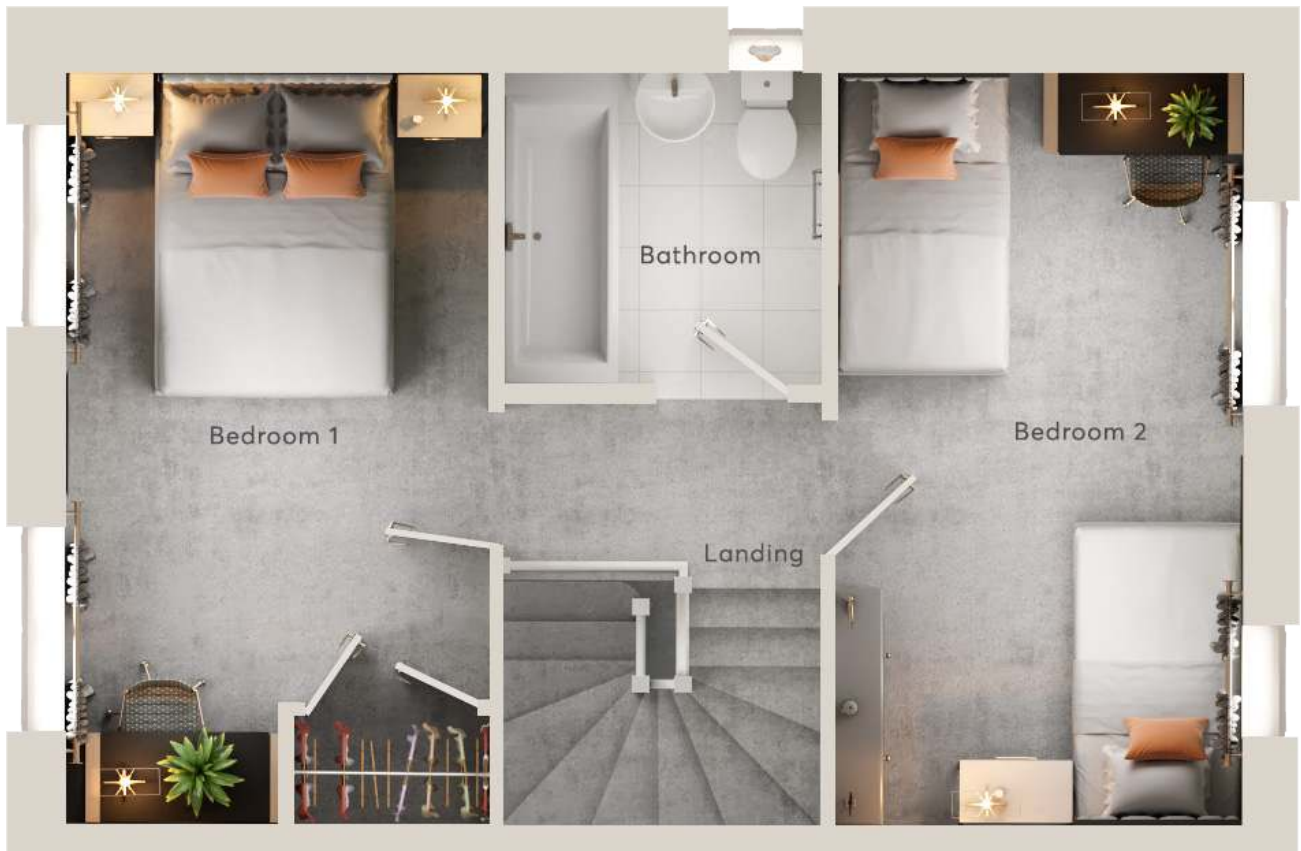

FIRST FLOOR

Bedroom 1	15'0" x 9'11"	4.57m x 3.03m
Bedroom 2	15'0" x 8'1"	4.57m x 2.47m
Bathroom	6'4" x 6'3"	1.94m x 1.91m

Important Notice

3D interactive site plan, 3D floorplans, CGI images and development layout is indicative only and subject to change. External finishes, materials, layouts, window positions and internal features may vary and 'upgrades and extras' may be shown. Room sizes are taken to the widest point in each room wall to wall and a tolerance of +/- 5% is allowed. The floor plans are for guidance only and may be subject to change and properties may be "handed" or mirror images of the plans shown. Please check with our Sales Consultant or Selling Agent.