

Handley Place

Handley Place, Locking, BS24 7LX



BLOCK 2



1 & 2 bedroom apartments



Floors 1, 2 and 3

Apartments 160 to 171

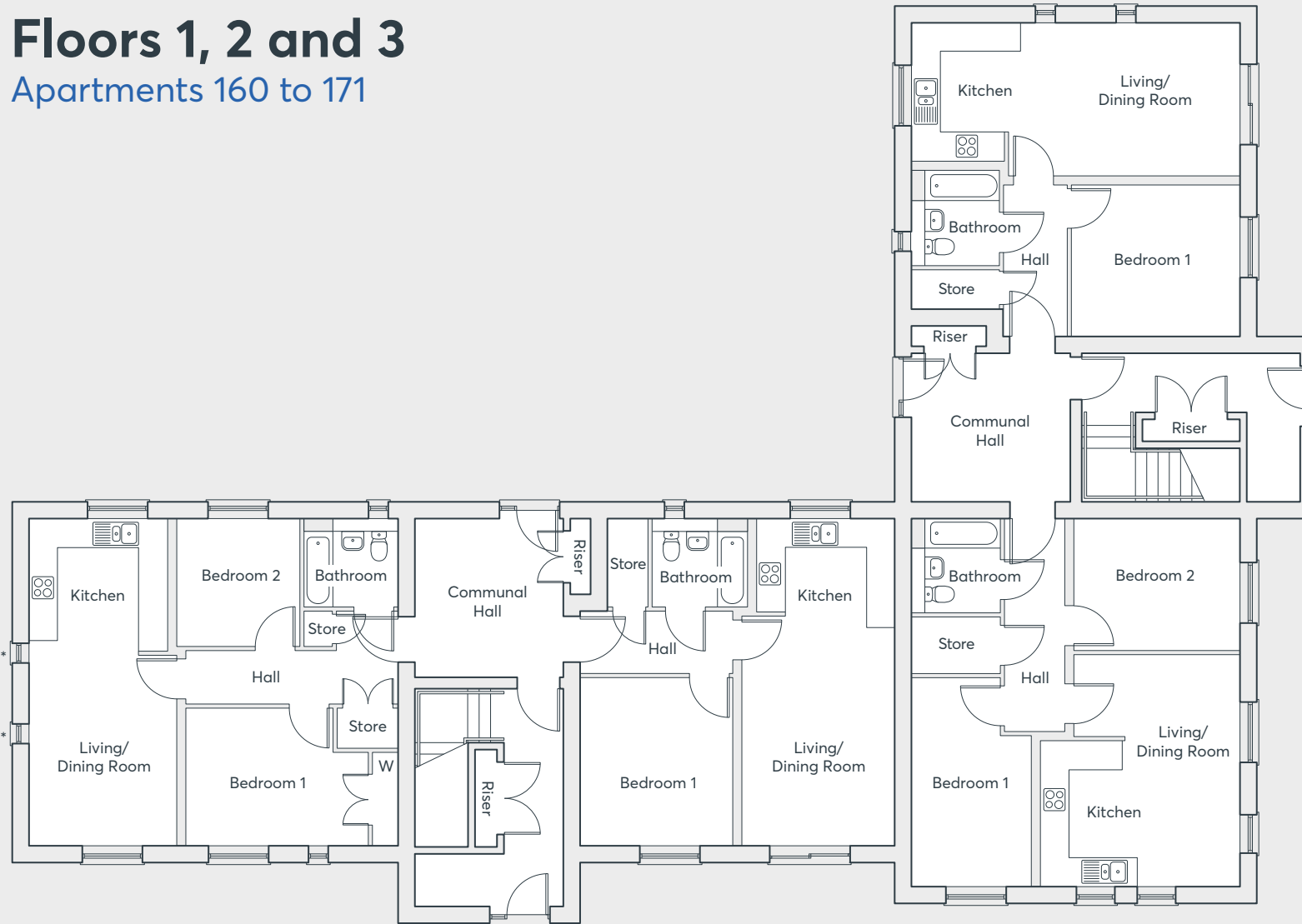

Apartments 160, 164 & 168

Living/Dining	4.94m × 3.46m	16'2" × 11'4"
Kitchen	2.45m × 3.13m	8'0" × 10'3"
Bedroom 1	3.80m × 3.43m	12'6" × 11'3"
Bathroom	2.00m × 2.15m	6'7" × 7'1"

Apartments 161, 165 & 169

Living/Dining/Kitchen	4.50m × 6.23m	14'9" × 17'2"
Bedroom 1	2.70m × 4.74m	8'10" × 15'5"
Bedroom 2	3.75m × 3.00m	12'4" × 9'10"
Bathroom	2.00m × 2.15m	6'7" × 7'1"

Apartments 163, 167 & 171

Living/Dining	3.35m × 4.31m	11'0" × 14'2"
Kitchen	3.13m × 2.99m	10'3" × 9'10"
Bedroom 1	4.09m × 3.12m	13'5" × 10'3"
Bedroom 2	2.76m × 2.89m	9'0" × 9'6"
Bathroom	2.15m × 2.00m	7'1" × 6'7"

Apartments 162, 166 & 170

Living/Dining	3.46m × 4.94m	11'4" × 16'2"
Kitchen	3.13m × 2.45m	10'3" × 8'0"
Bedroom 1	3.45m × 3.80m	11'4" × 12'6"
Bathroom	2.15m × 2.00m	7'1" × 6'7"

Computer generated images are indicative only. External finishes, materials, layouts, window positions and styles may vary. Room sizes are taken to the widest point in each room wall to wall and a tolerance of +/- 5% is allowed. The floor plans are for guidance only and may be subject to change and properties may be "handed" or mirror images of the plans shown. Please check with our Sales Consultant or Selling Agent.

* Windows on plots 167 & 171 only



**CONSUMER
CODE FOR
HOME BUILDERS**
www.consumercode.co.uk



St. Modwen Homes, Two Devon Way, Longbridge, Birmingham, B31 2TS
T: 0121 647 1000 E: sales@stmodwenhomes.co.uk

stmodwenhomes.co.uk